

# 电磁式/磁电式转速传感器 形状分类表

MP-900/9000 系列 (电磁式)

不需要电源

MP-9810/9830/AP-981 (磁电式)

超低速/高速/防酸防浸型

A 测量频率范围

B 检测齿轮模数

MP-936

A 300~35,000 (Hz)  
B 1~3

防护型

耐热  
220°C

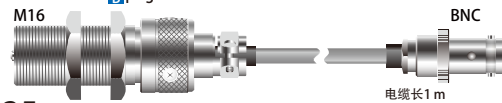

MP-935

A 300~35,000 (Hz)  
B 1~3

1) 防油/耐热  
150°C

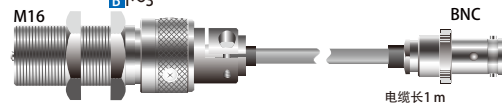

MP-930

A 200~35,000 (Hz)  
B 1~3

1) 防油

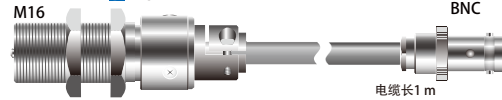

1)符合日本电机工业标准JEM-1030-1983, 防油

MP-9810

A 0 Hz ~20 kHz  
B 0.5 ~3

超低速·高速

磁电式

MP-9830

A 0 Hz ~100 kHz  
B 0.5 ~3

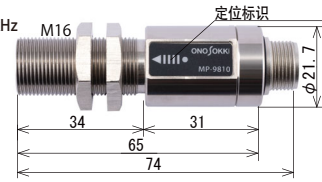

MP-9810/9830  
AP-981安装时  
定位标识需对  
准检测齿轮中心



AP-981

A 1 ~20,000 (Hz)  
B 1 ~3

2) 防酸·防浸

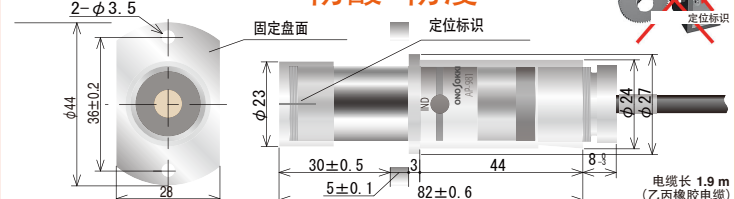

2)符合JISCO920 防水试验的防护等级 IPX7 防浸

MP-992

A 400~100,000 (Hz)  
B ~3

小型

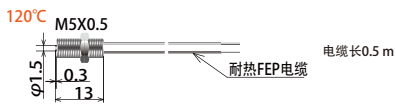

MP-950

A 300~35,000 (Hz)  
B 1~3

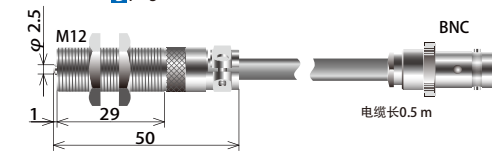

MP-962

A 400~35,000 (Hz)  
B 1~3

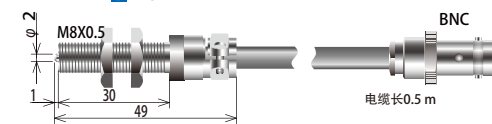

(通用型) MP-9100

A 200~35,000 (Hz)  
B 1~3

通用型

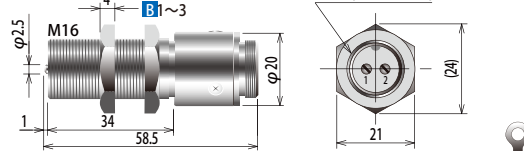

MP-911

A 200~35,000 (Hz)  
B 1~3

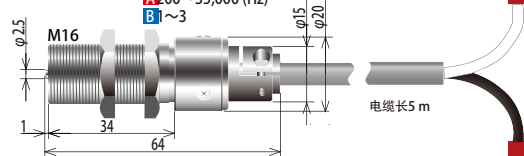

MP-9200

A 300~35,000 (Hz)  
B 0.5~1

小模数



MP-963

A 45~15,000 (Hz)  
B 3~10

中模数

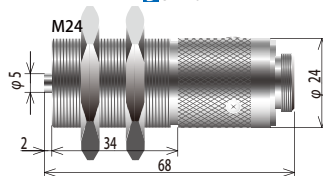

MP-9120

A 200~80,000 (Hz)  
B 1~3

高速用



MP-940A

A 300~35,000 (Hz)  
B 1~3

长型

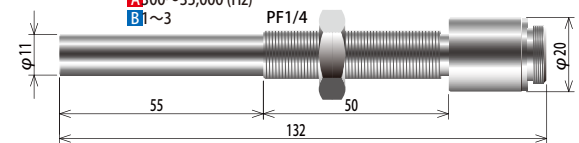

MP-954

A 300~35,000 (Hz)  
B 1~3

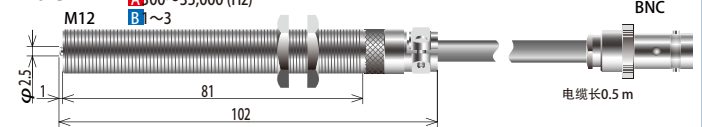

安装示意图

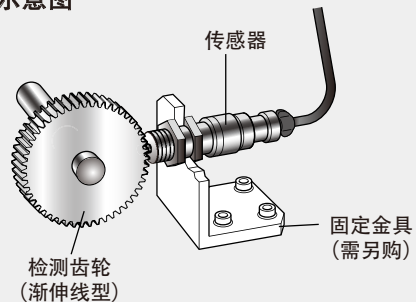

MP-001

MP系列用标准检测齿轮

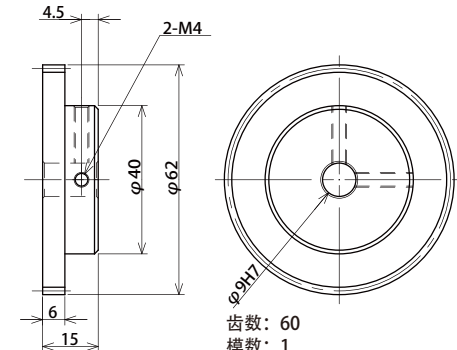

齿数: 60  
模数: 1  
材质: SS400(表面处理: 三价铬酸盐 白)